

## LO D10-1

Choke can be made on the annealed laminations thick of 0.3 mm for an additional charge 12USD. The OT10 cover fits perfectly to D10-1.

## Caption

|                  |                                |       |            |
|------------------|--------------------------------|-------|------------|
| L                | inductance, $f = 120\text{Hz}$ | price | price      |
| sizes            | overall dimensions             | core  | core type  |
| weight           | approximate weight             | R     | resistance |
| I <sub>max</sub> | maximum current                |       |            |

## Specyfikacje

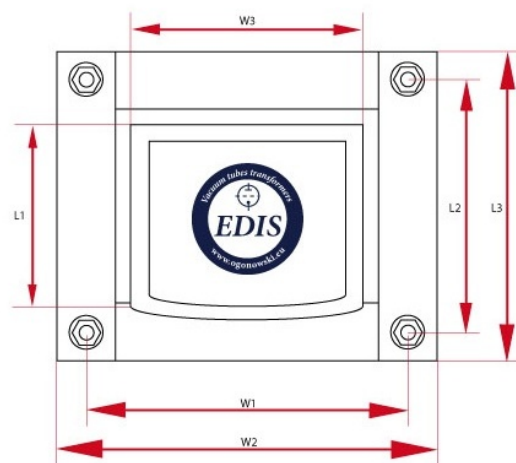
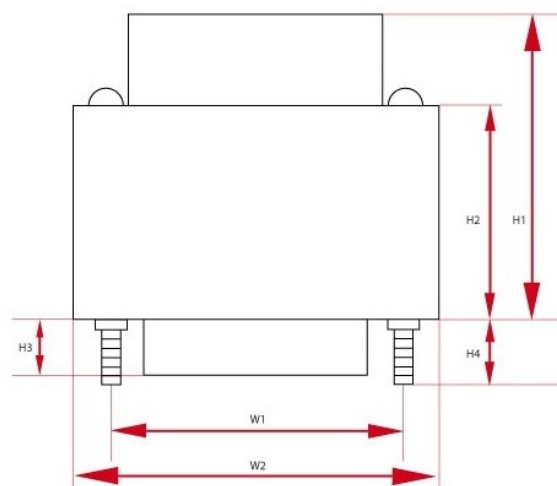

| Choke - LO D10-1 - wersja z jednym dekielkiem (PL) |      |                  |         |   |                            |  |        |       |
|--|------|------------------|---------|---|----------------------------|--|--------|-------|
| L  | R    | I <sub>max</sub> | Core    | Size W                                    | Size H                     | Size L   | Weight | Count |
| 10 H   | 72 Ω | 300 mA           | EI84/42 | W1 - 110 mm<br>W2 - 110 mm<br>W3 - 110 mm | H1 - 110 mm<br>H2 - 110 mm | L1 - 110 mm<br>L2 - 110 mm<br>L3 - 110 mm<br>L4 - 110 mm | 1.9 kG | 1     |

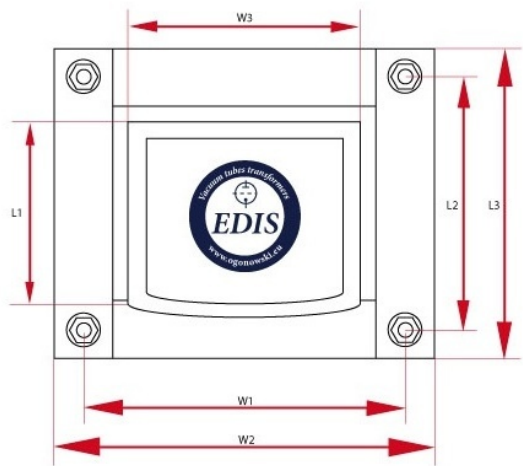
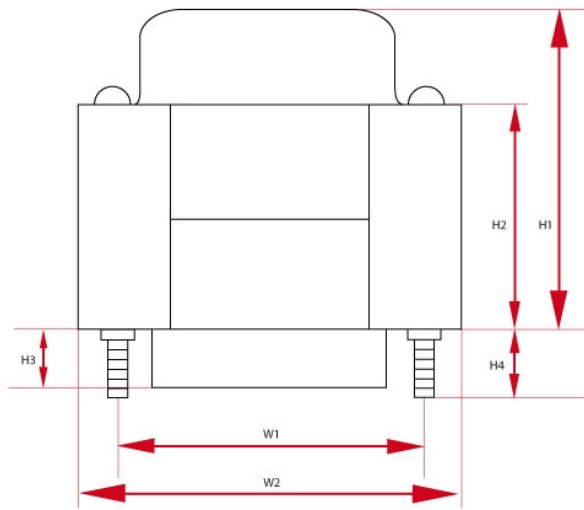

Choke - LO D10-1 - wersja z jednym dekielkiem (DE)

| L    | R    | I <sub>max</sub> | Core    | Size W                                    | Size H                     | Size L   | Weight | Count |
|------|------|------------------|---------|---|----------------------------|--|--------|-------|
| 10 H | 72 Ω | 300 mA           | EI84/42 | W1 - 110 mm<br>W2 - 110 mm<br>W3 - 110 mm | H1 - 110 mm<br>H2 - 110 mm | L1 - 110 mm<br>L2 - 110 mm<br>L3 - 110 mm<br>L4 - 110 mm | 1.9 kG | 1     |