

## LO D75-1

Choke can be made on the annealed laminations thick of 0.3 mm for an additional charge 6USD.

## Caption

sizes	overall dimensions	price	price
weight	approximate weight	$I_{max}$	maximum current
core	core type	L	inductance, $f = 120\text{Hz}$
R	resistance		

## Specyfikacje

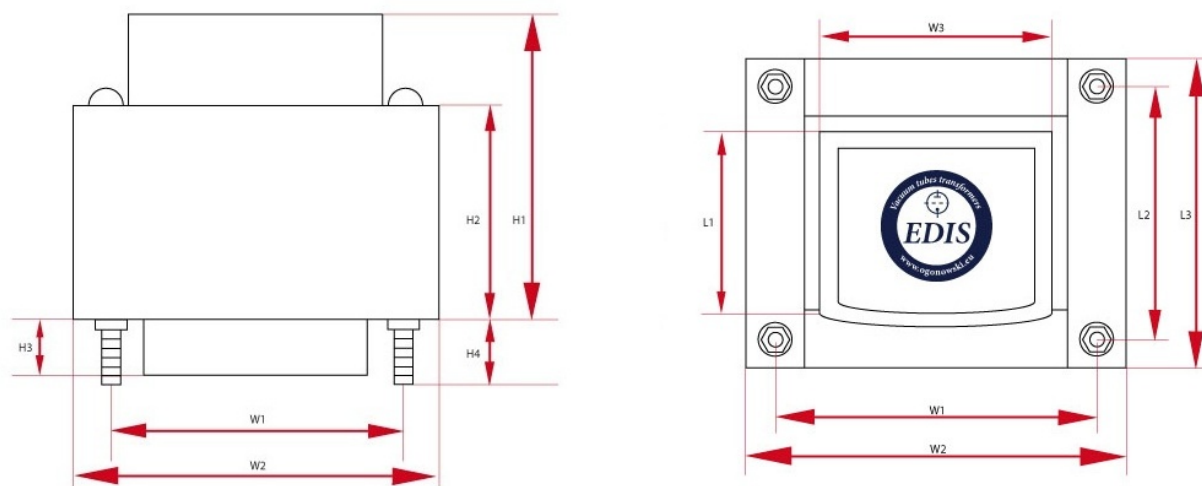

Choke - LO D75-1 - wersja z jednym dekielkiem (PL)

L	R	$I_{max}$	Core	Size W	Size H	Size L	Weight	Count
75 H	1800 $\Omega$	20 mA	EI54/18	W1 - 110 mm W2 - 110 mm W3 - 110 mm	H1 - 110 mm H2 - 110 mm	L1 - 110 mm L2 - 110 mm L3 - 110 mm L4 - 110 mm	0.37 kG	1

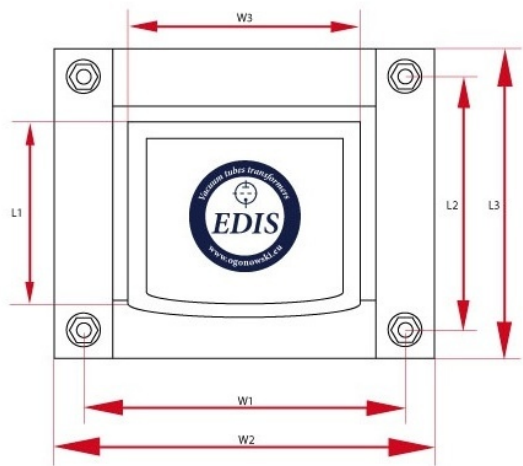
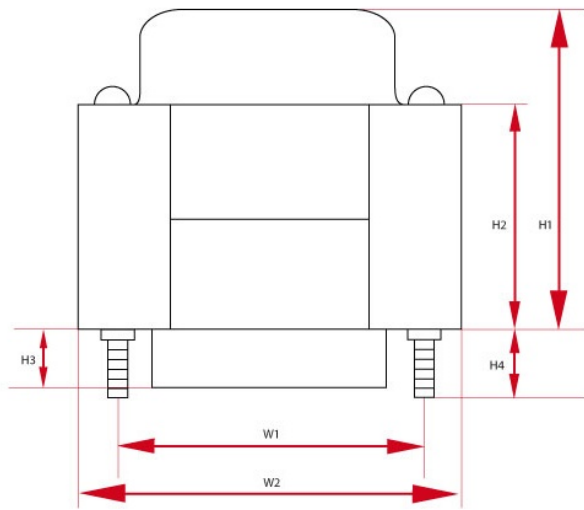

Choke - LO D75-1 - wersja z jednym dekielkiem (DE)

L	R	$I_{\max}$	Core	Size W	Size H	Size L	Weight	Count
75 H	1800 $\Omega$	20 mA	EI54/18	W1 - 110 mm W2 - 110 mm W3 - 110 mm	H1 - 110 mm H2 - 110 mm	L1 - 110 mm L2 - 110 mm L3 - 110 mm L4 - 110 mm	0.37 kG	1