

PP40-G1

Guitar Ra Transformer 8000Ω of 40W.

Caption

weight	approximate weight	R_o	load resistance
$k_{n:n}$	transmission	L_{aa}	inductance of the anode-anode, $f=120\text{Hz}$
Z_{aa}	anode-anode impedance	f_{\max}	maximum frequency
R_{aa}	resistance of the anode-anode	price	price
sizes	overall dimensions	P_{\max}	maximum power
UL	peel off the ultra-linear	I_{\max}	maximum current
f_{\min}	minimum frequency	core	core type

Specyfikacje

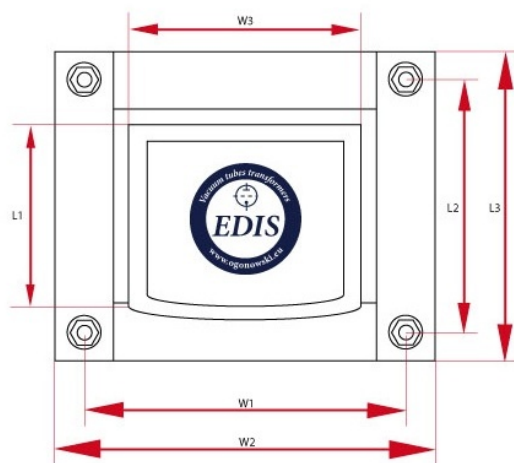
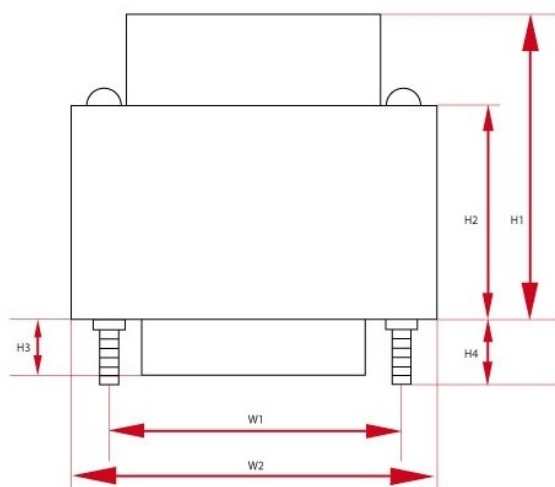

Push Pull - PP40-G1 - wersja z jednym dekielkiem (PL)							
P_{\max}	Z_a	I_{\max}	R_{aa}	UL	$k_{n:n}$	R_o	L_a
40 W	8000 Ω	150 mA	-	-	-	4, 8 and 16 Ω	-
f_{\min}	f_{\max}	Core	Size W	Size H	Size L	Weight	Count
30Hz @ -3dB	3-kHz @ -3dB	EI84/42	W1 - 110 mm W2 - 110 mm W3 - 110 mm	H1 - 110 mm H2 - 110 mm	L1 - 110 mm L2 - 110 mm L3 - 110 mm L4 - 110 mm	2 kG	1

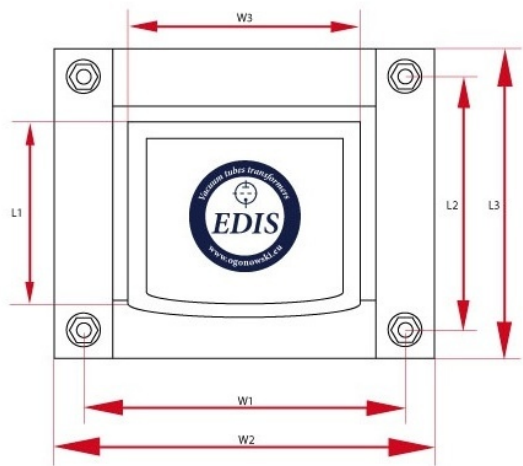
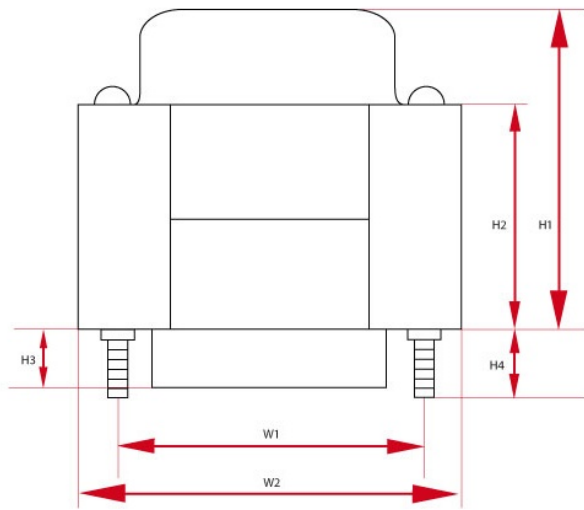

Push Pull - PP40-G1 - wersja z jednym dekielkiem (DE)

P_{max}	Z_a	I_{max}	R_{aa}	UL	$k_{n:n}$	R_o	L_a
40 W	8000 Ω	150 mA	-	-	-	4, 8 and 16 Ω	-
f_{min}	f_{max}	Core	Size W	Size H	Size L	Weight	Count
30Hz @ -3dB	3-kHz @ -3dB	EI84/42	W1 - 110 mm W2 - 110 mm W3 - 110 mm	H1 - 110 mm H2 - 110 mm	L1 - 110 mm L2 - 110 mm L3 - 110 mm L4 - 110 mm	2 kG	1